

Instructions

Notice de montage

Bauanleitung

Istruzioni di montaggio

Instrucciones de montaje

Instruções de montagem

Monteringsanvisning

Kokoamisohje

Monterings instruktioner

Montagehandleiding

Οδηγίες συναρμολόγησης.

組立説明書





- Ⓒ The battery housing and the motor shown in the instructions have been replaced.
- Ⓕ Le boîtier de piles et le moteur présentés dans la notice ont été remplacés.
- Ⓓ Das in der Gebrauchsanweisung gezeigte Batteriegehäuse sowie der Motor wurden ersetzt.
- Ⓘ Il vano pile ed il motore presentati nelle istruzioni per l'uso sono stati sostituiti.
- Ⓔ La caja de pilas y el motor presentados en las instrucciones han sido sustituidos.
- ⒠ O compartimento de pilhas e o motor apresentados nas instruções foram substituídos.
- Ⓔ Batterilådan och motorn som presenteras i notisen har ersatts.
- Ⓕ Ohjekirjassa esitetyt paristokotero ja moottori on vaihdettu.
- Ⓕ Batteridåsen og motoren, som er vist i vejledningen, er blevet udskiftet.
- Ⓖ Het batterijcompartiment en de motor uit de handleiding zijn vervangen.
- Ⓖ Το πακέτο μπαταριών και το μοτέρ που παρουσιάζονται στις οδηγίες αντικαταστάθηκαν.
- Ⓖ モデル組立てを目録にするために、説明書内の電池ボックスとモータが新型になりました。

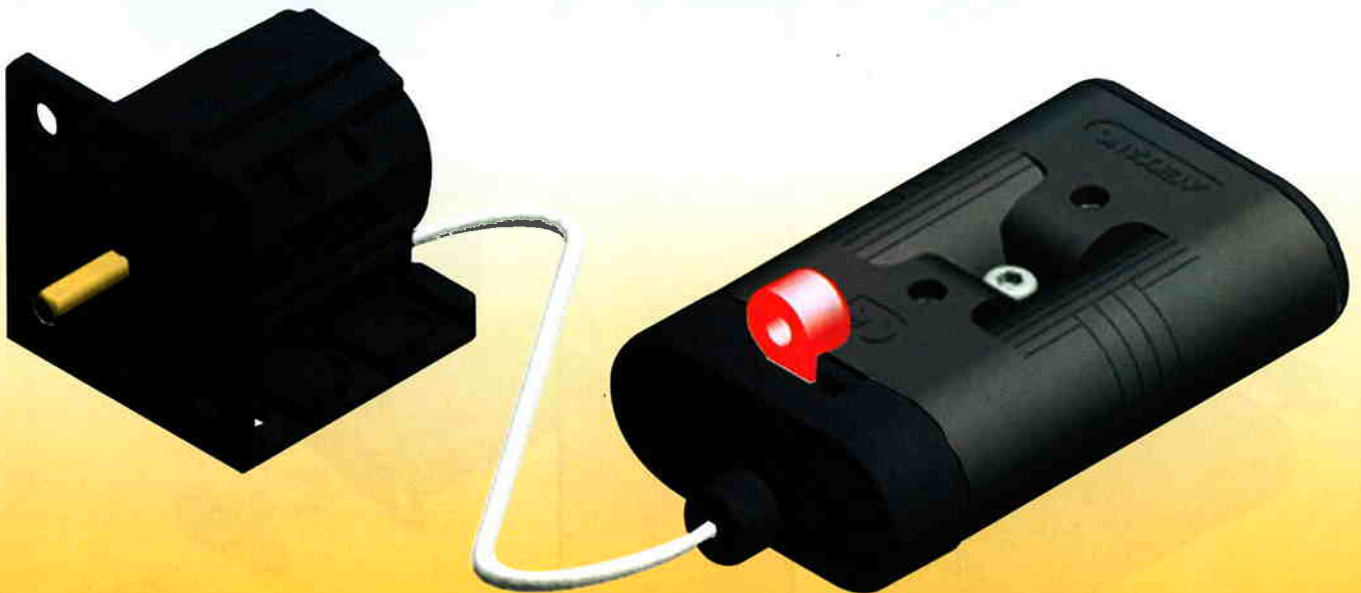
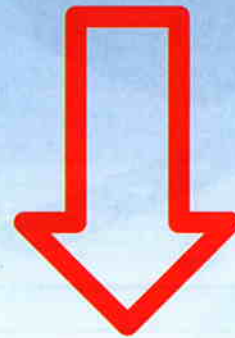
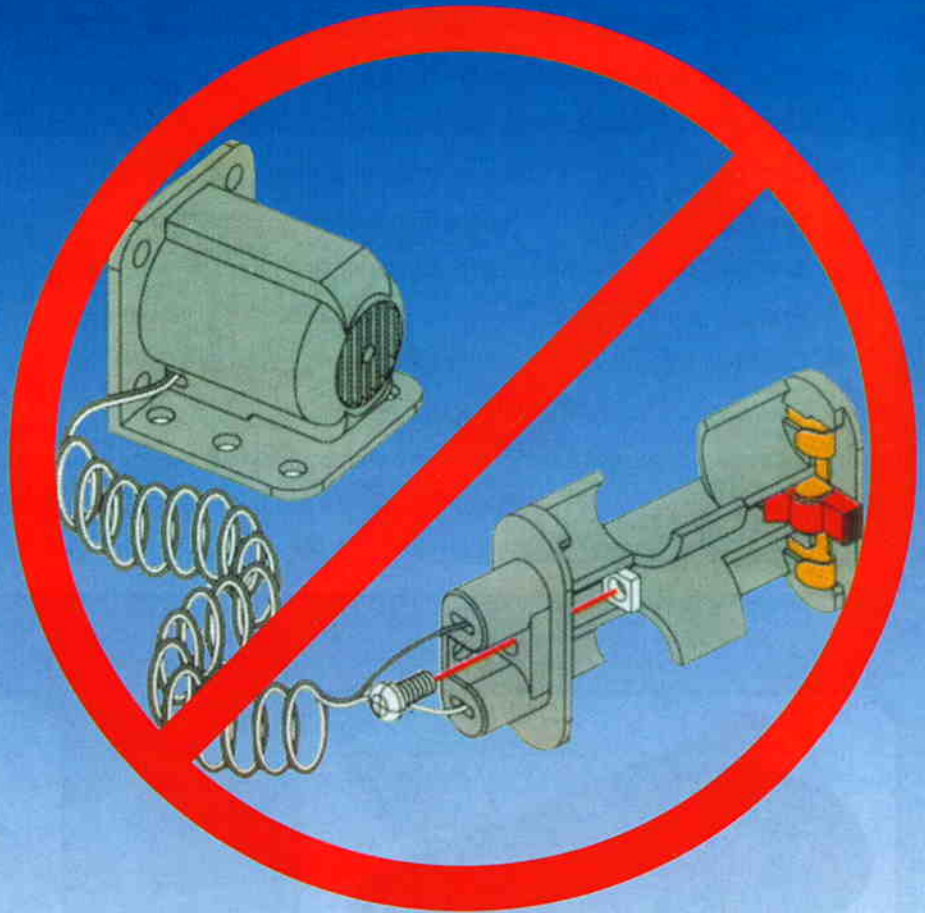

- ⓖⓑ Assembly examples of the new battery housing and the new motor.
- ⓕⓁ Exemples de montage du nouveau boîtier de piles et du nouveau moteur.
- ⓓⓂ Montagebeispiele mit dem neuen Batteriegehäuse und dem neuen Motor.
- ⓐⓁ Esemplio di montaggio del nuovo vano pile e del nuovo motore.
- ⓔⓂ Ejemplos de montaje de la nueva caja de pilas y del nuevo motor.
- ⓖⓁ Exemplos de montagem do novo compartimento de pilhas e do novo motor.
- ⓈⓂ Exempel på montering av den nya batterilådan och den nya motorn.
- ⓕⓂⓃ Uuden paristolokeron ja uuden moottorin asennusesimerkki.
- ⓓⓀ Eksempler på montering af den nye batteridåse og den nye motor.
- ⓃⓁ Montagevoorbeelden van het nieuwe batterijcompartiment en de nieuwe motor.
- ⓖⓂ Παράδειγματα συναρμολόγησης του νέου πακέτου μπαταριών και του νέου μοτέρ.
- ⓐⓃⓃ 新型電池ボックスと新型モータの組立て例

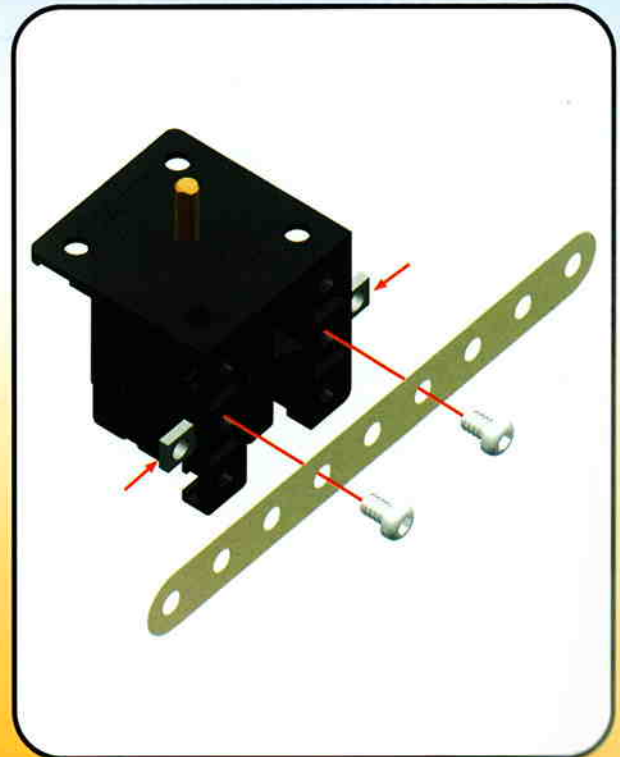
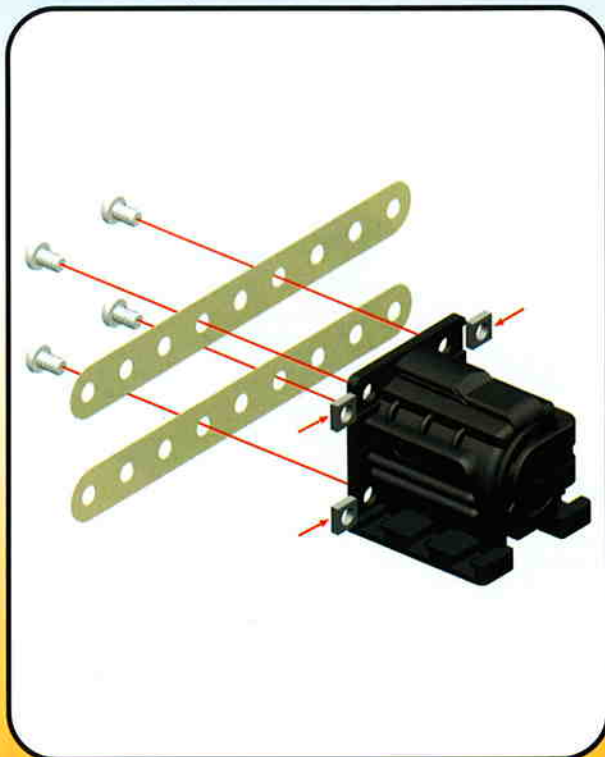
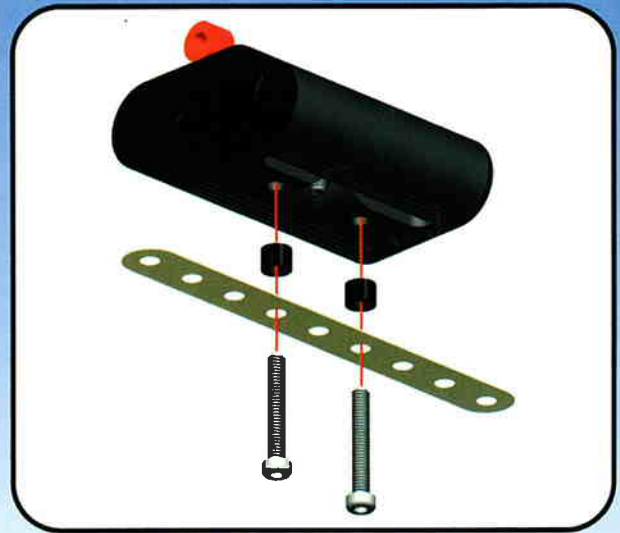
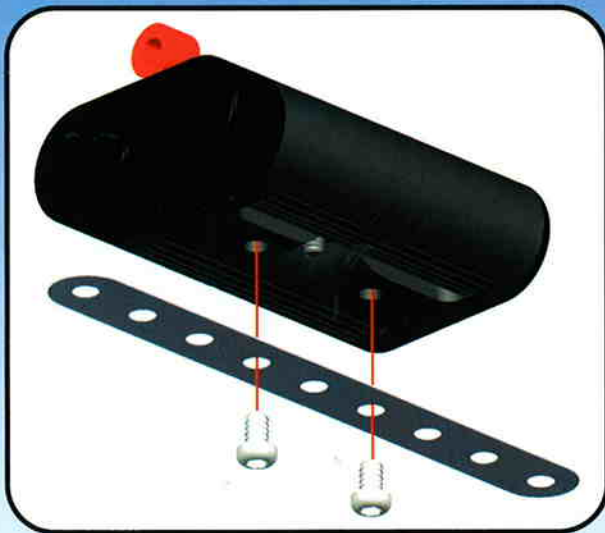

1



2



3



4



5

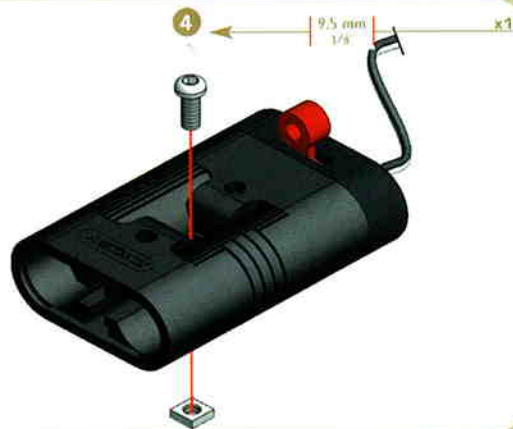

6



7

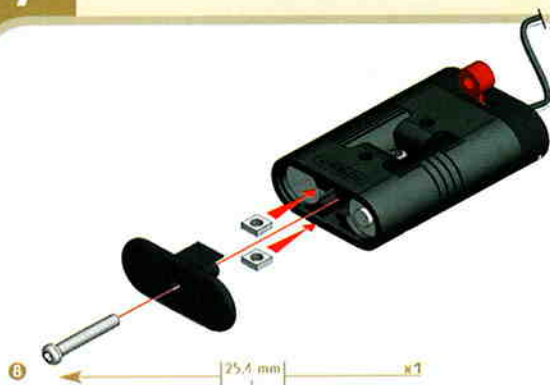

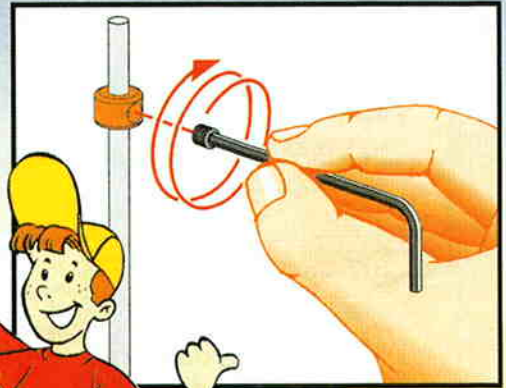
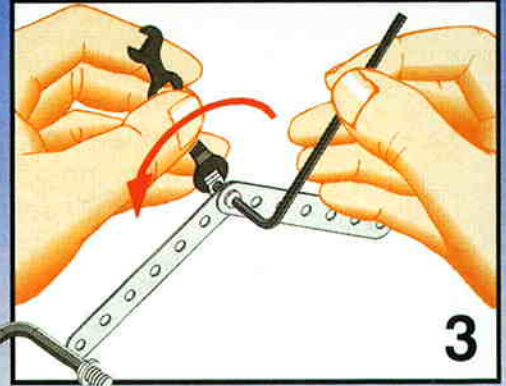
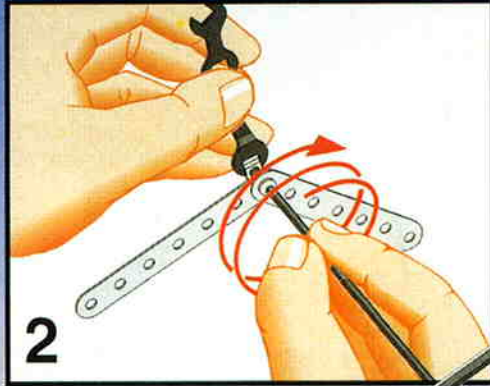
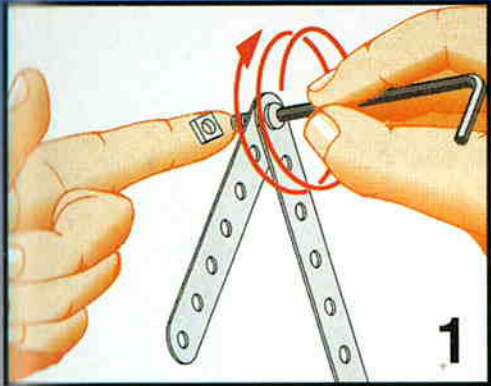

[89] x 8
 [89] x 4
 [89] x 4
 [236] x 1
 [1] x 4
 [46a] x 1
 [48a] x 4
 [48] x 1
 [1A] x 2
 [1B] x 16
 [12] x 4
 [12c] x 8
 [2] x 4
 [3] x 2
 [4] x 2
 [51] x 3
 [51] x 3
 [51] x 2
 [77] x 2
 [51] x 2
 [2] x 4
 [6] x 12
 [6] x 10
 [6] x 10
 [27A] x 1
 [21] x 1
 [22] x 1
 [32] x 1
 [37b] x 120
 [69a] x 3
 [38] x 12
 [37a] x 133
 [23c] x 22
 [38a] x 16
 [111] x 2
 [111a] x 8
 [111c] x 3
 [13 cm] [15] x 1
 [9 cm 3/8"] [16] x 8
 [6 cm 1/2"] [16a] x 2
 [109] x 2
 [700] x 1
 [720] x 1
 x 2
 x 2
 x 1
 x 1
 [186A] x 2
 [36c] x 1
 [36d] x 1
 [34] x 1



Discover the method of assembling with screws and nuts, the tools and their use, the set-up principles, the fun of building working models.

Follow the step by step assembly ; this progression will guide you and you will succeed in making the models.

Choose the necessary parts by following each step.

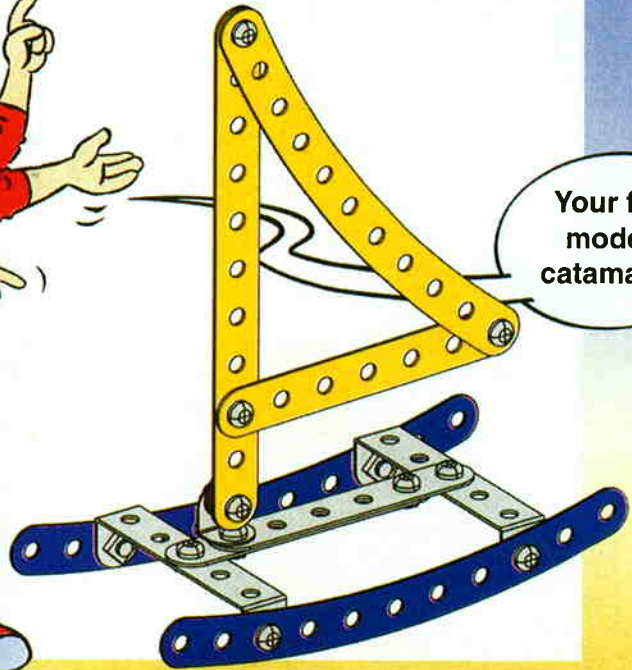

Your first model : catamaran.

1

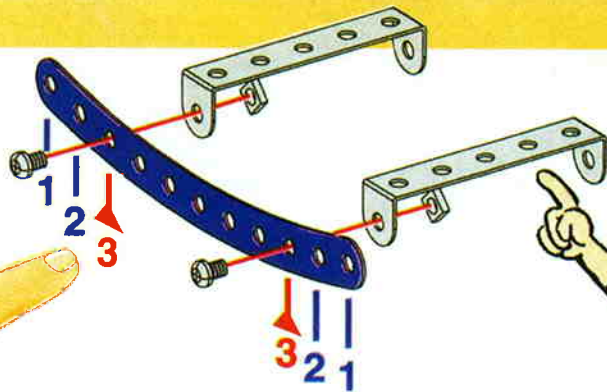
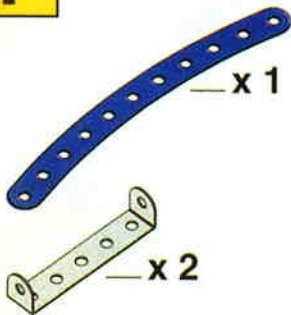

2 1+

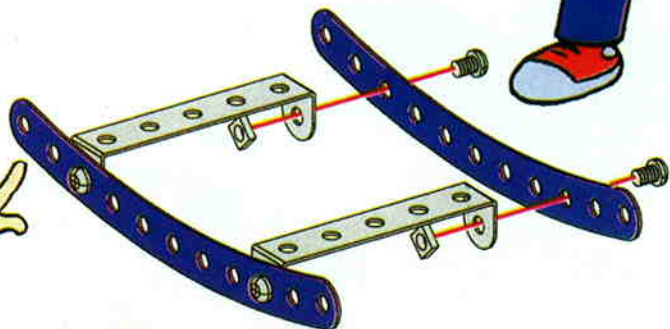
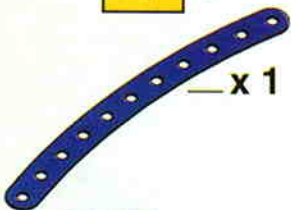

3

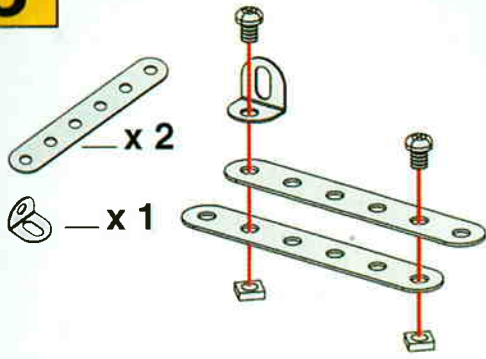

4

2 + 3

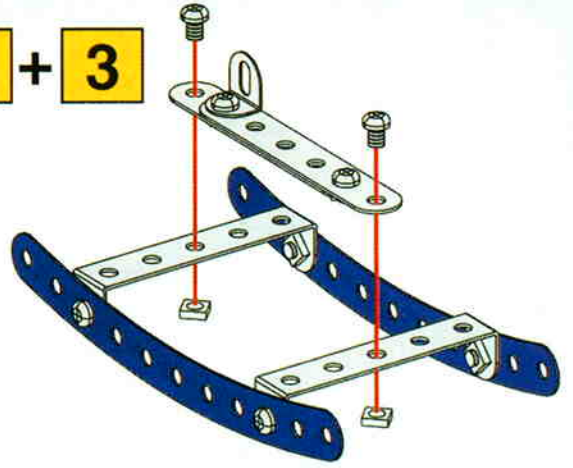

5

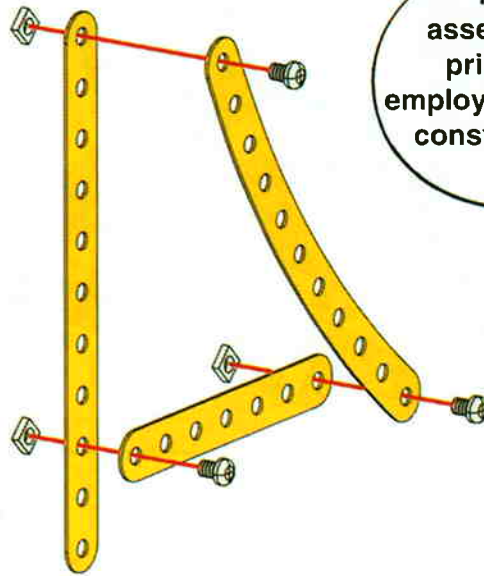
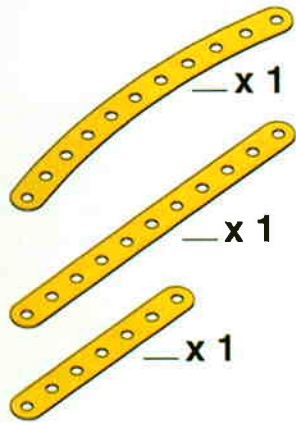

Rigid assemblies :
principles
employed for solid
constructions.

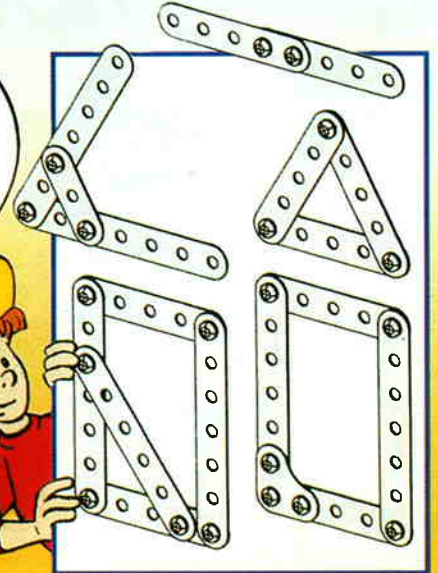

6

4 + 5 +

③ | 12 mm | x 1
● x 1

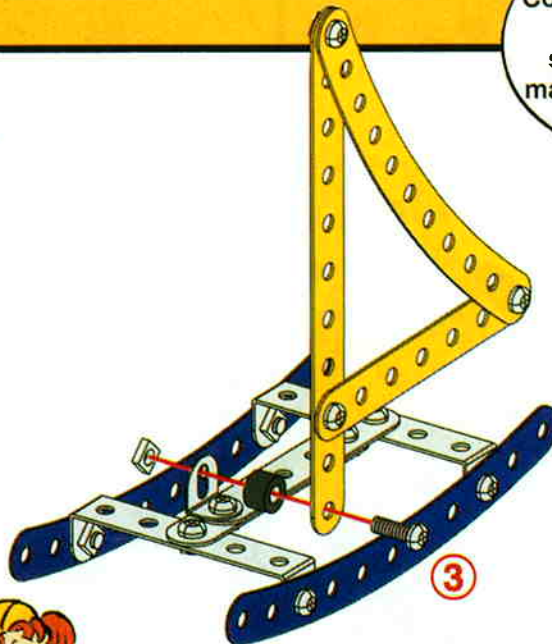

It works !
Congratulations !
You have
succeeded in
making your first
model !





1

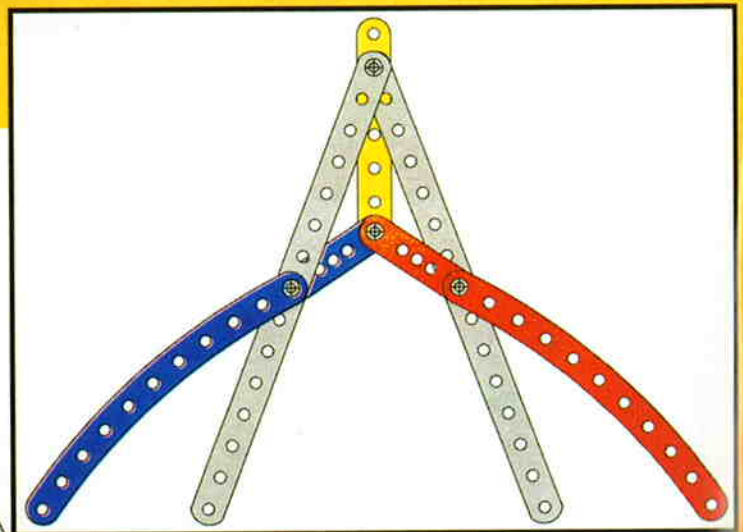
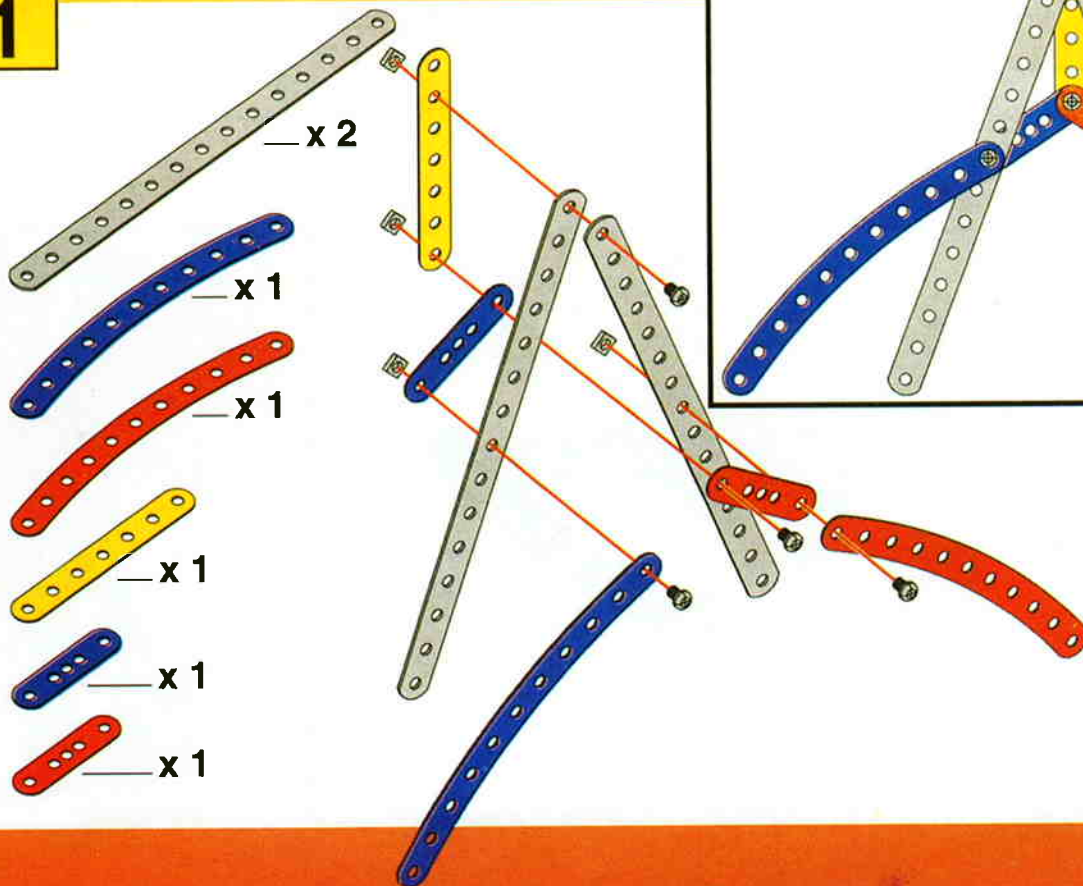

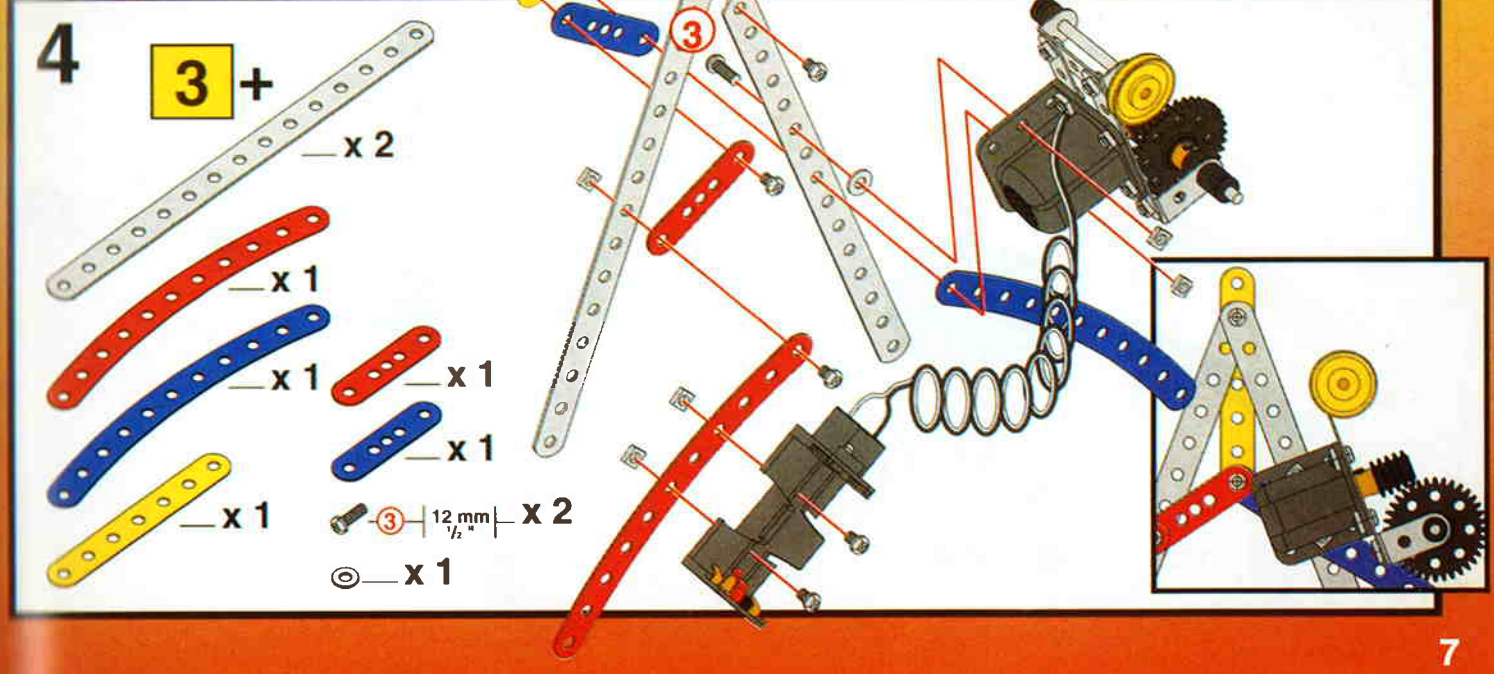
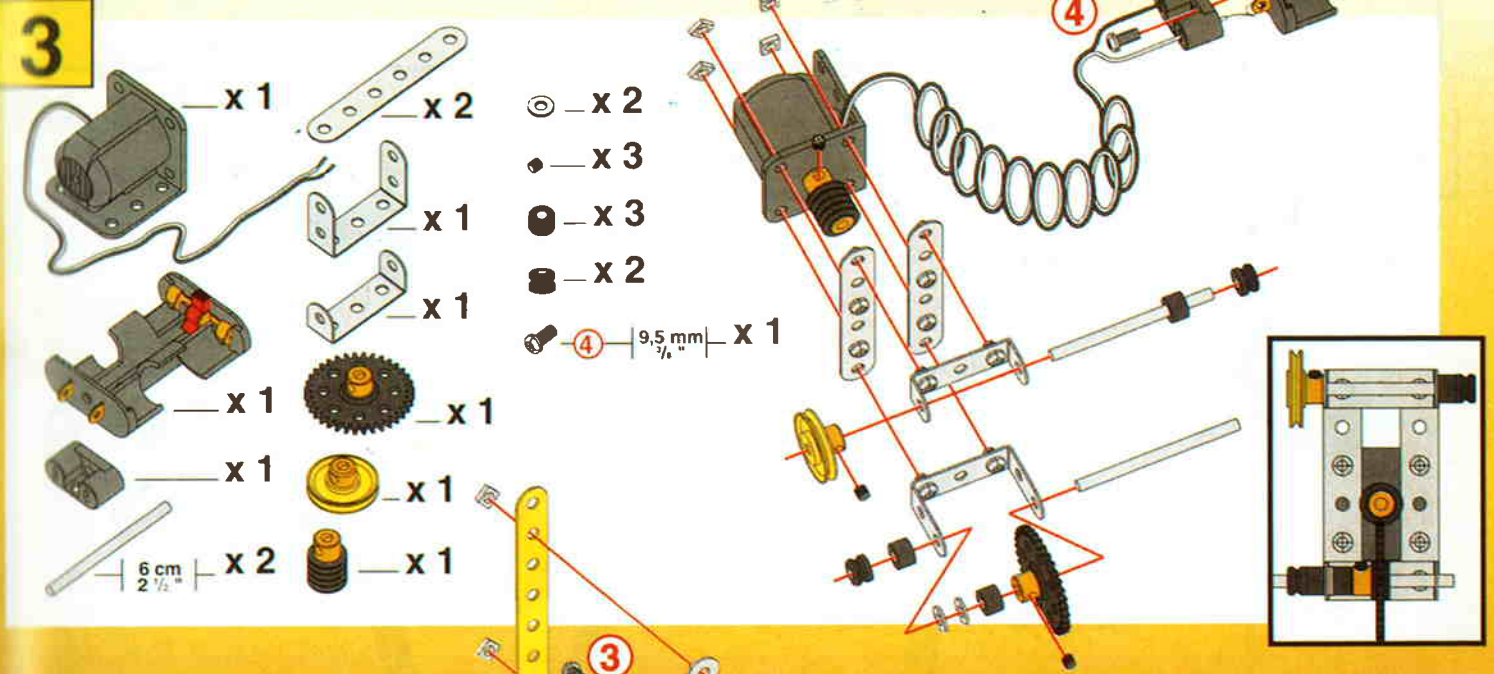
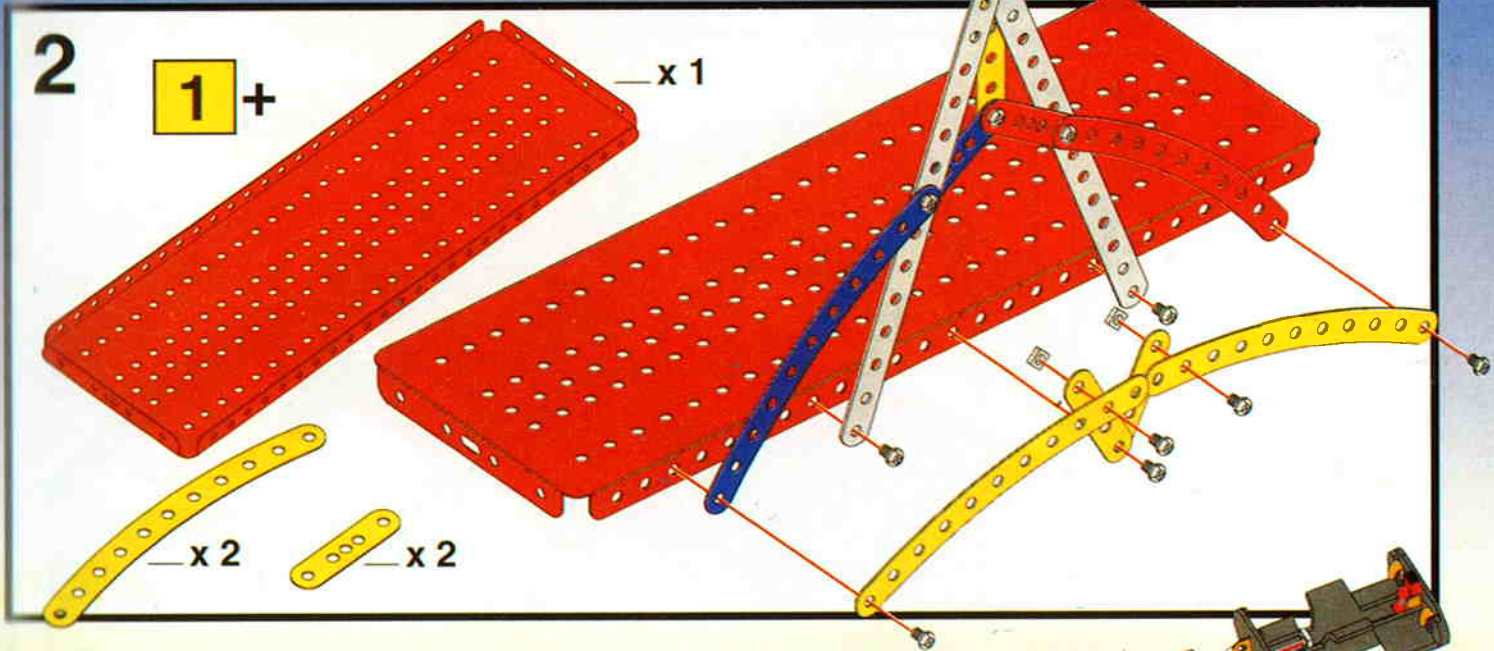





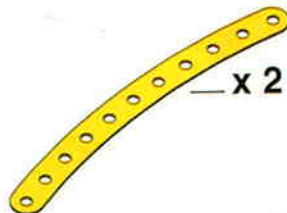
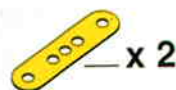

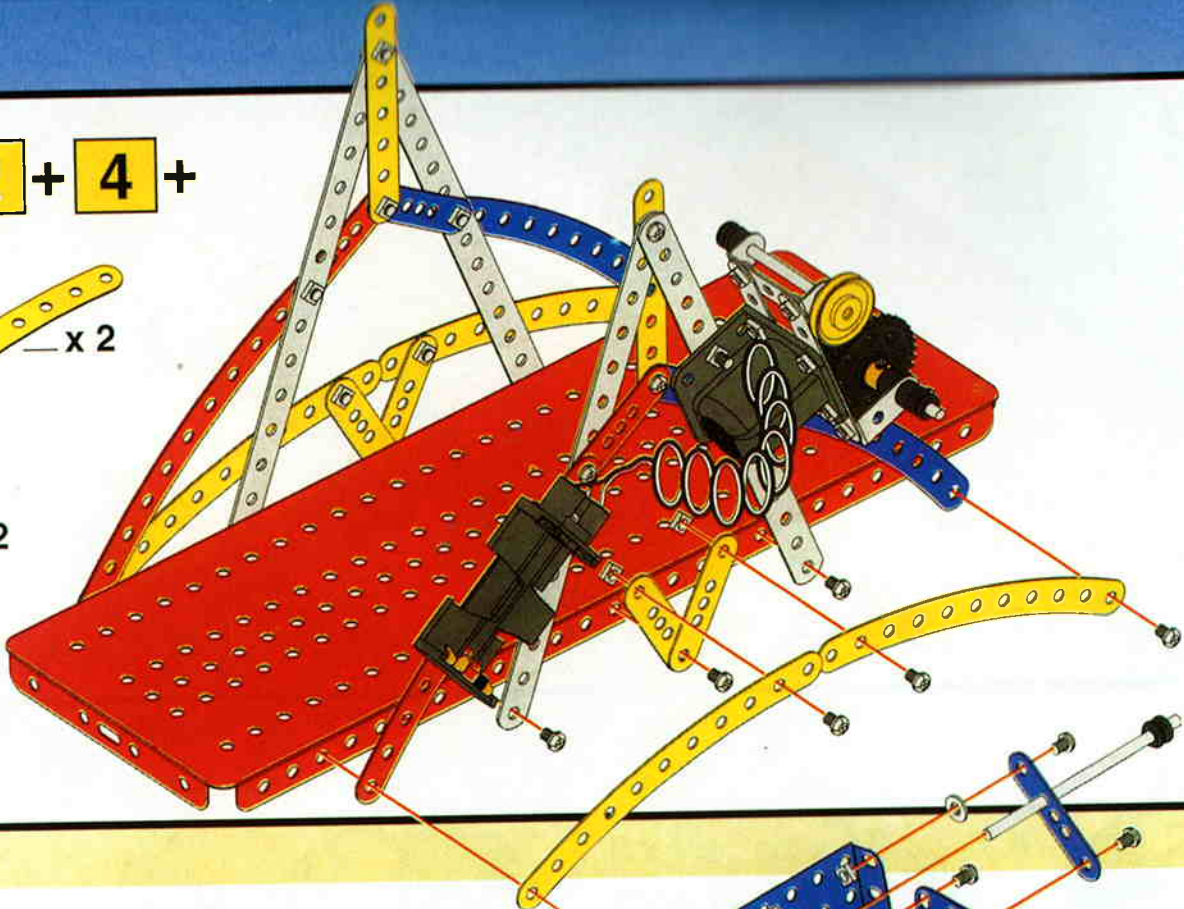

5

2 + 4 +

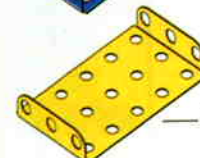
-  — x 2
-  — x 2



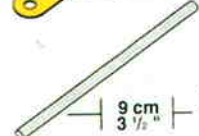

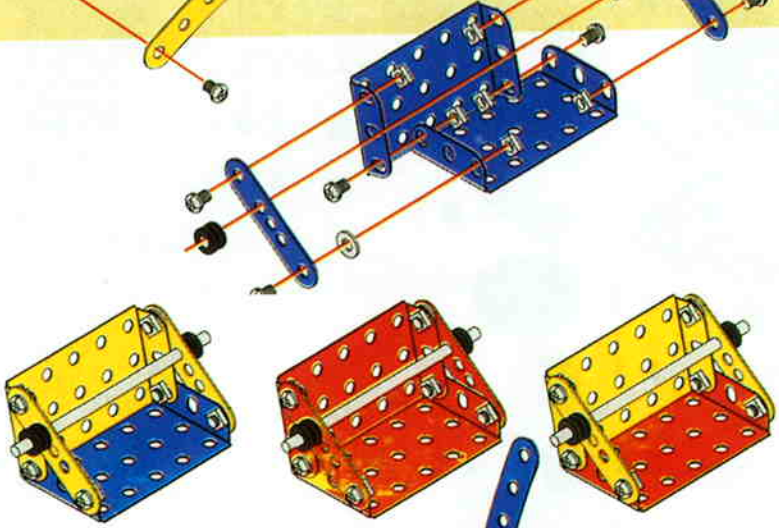

6

-  — x 3
-  — x 3
-  — x 2
-  — x 2
-  — x 2
-  — x 4
-  — x 4
-  — x 8
-  — x 8

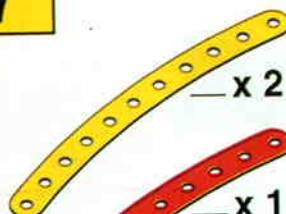
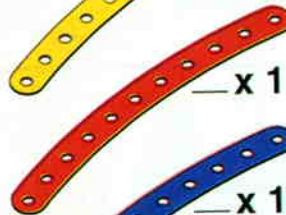
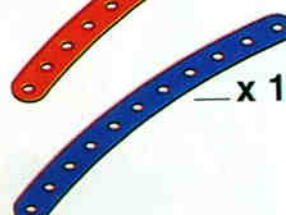

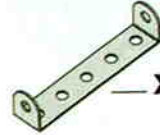
7

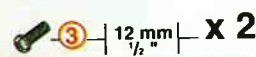
-  — x 2
-  — x 1
-  — x 1
-  — x 1
-  — x 2
-  — x 2
-  — x 2

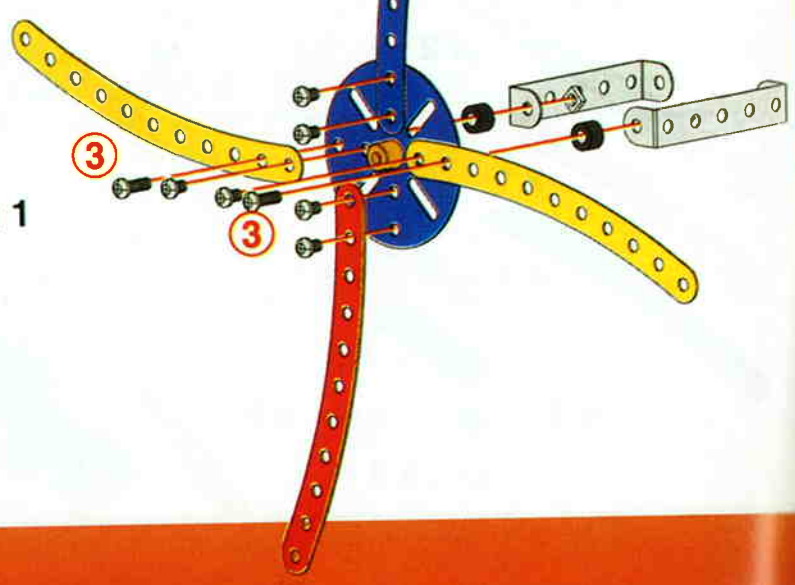

8

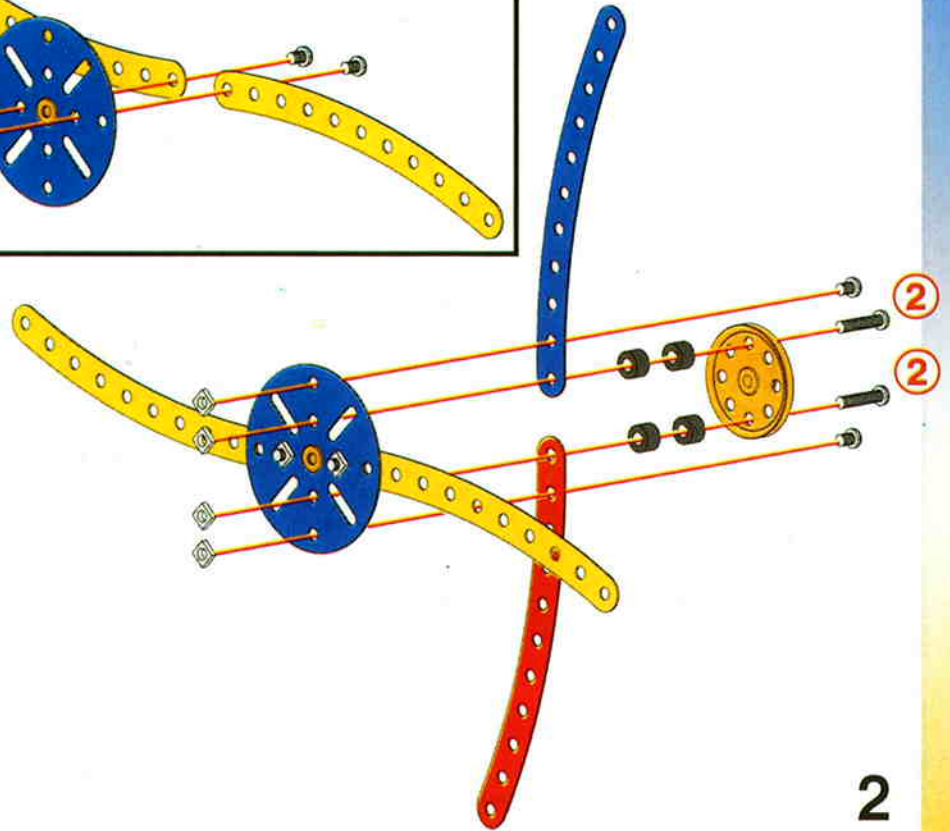
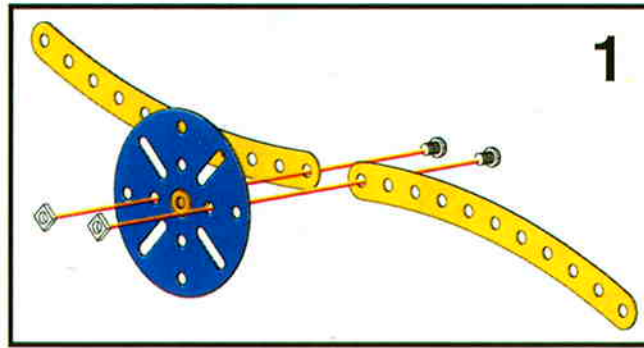
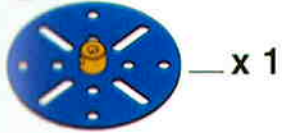
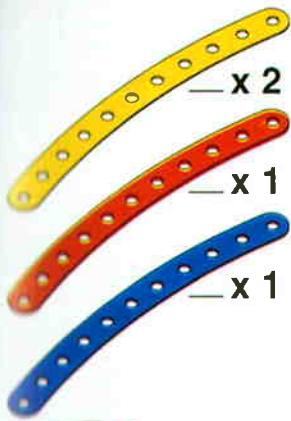

2

9

7 + 8 +

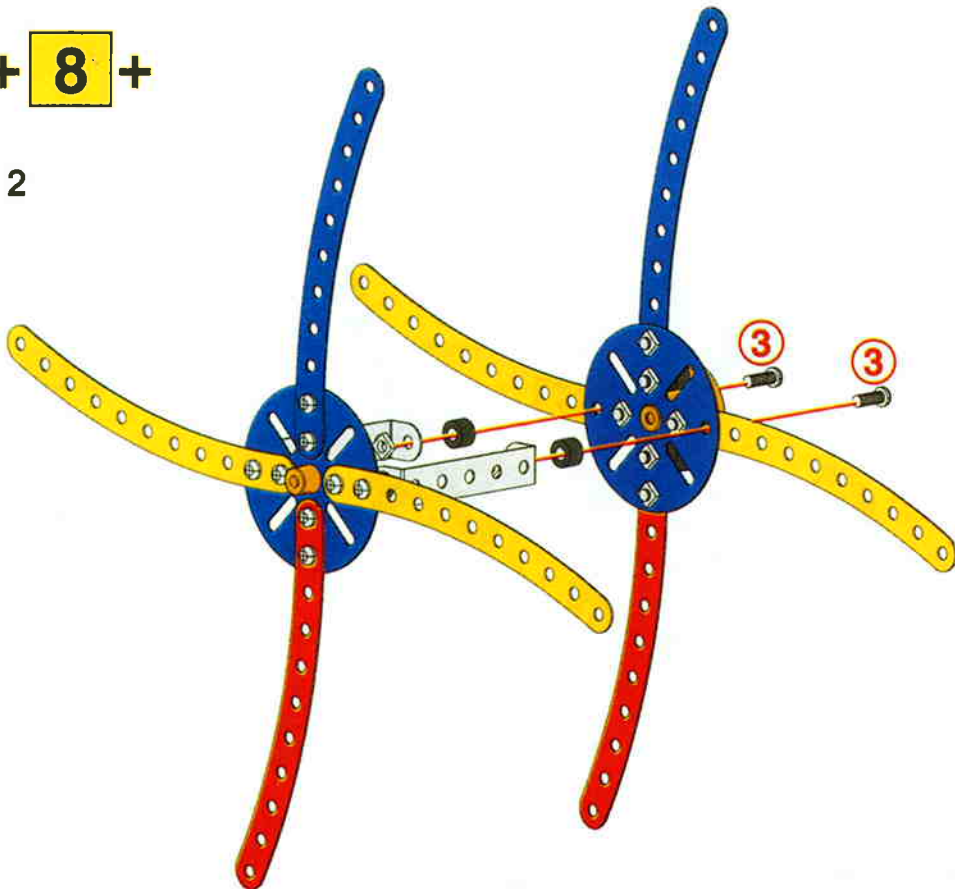
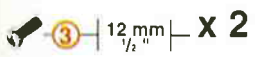

9

10 5 + 9 +

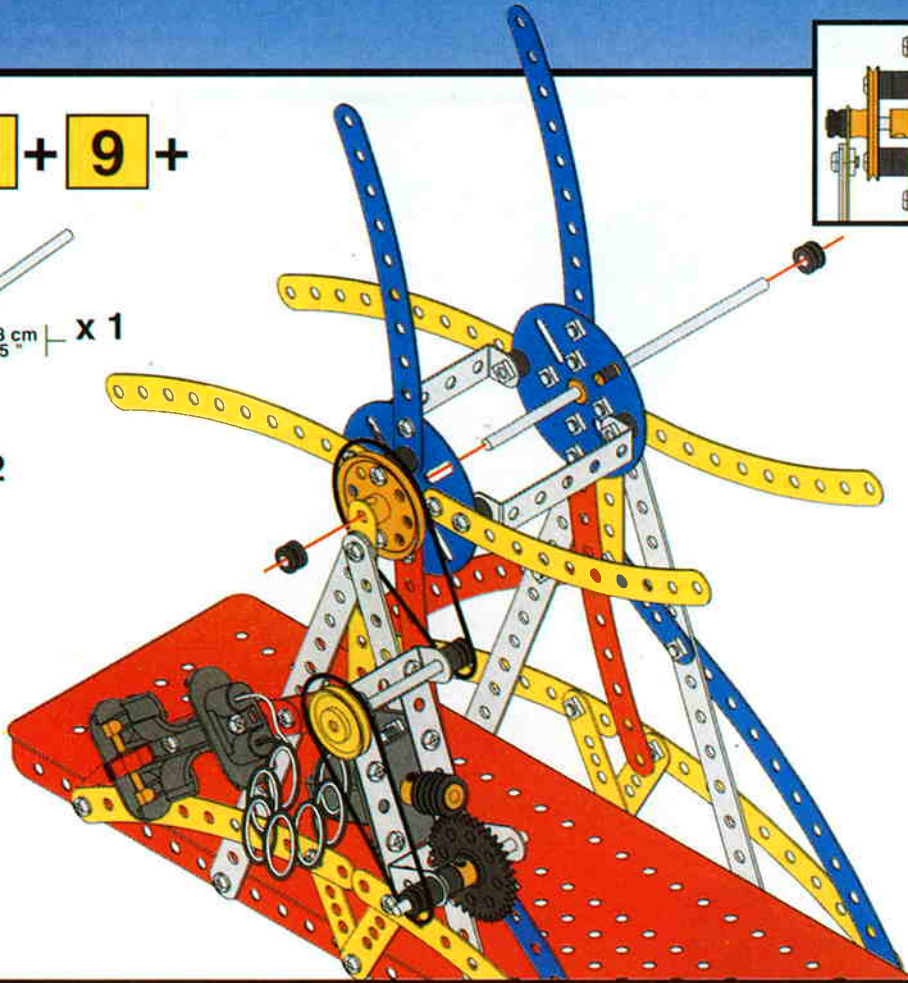
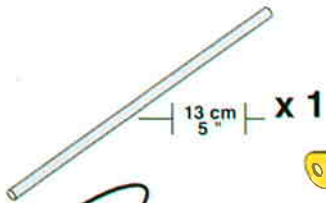

11 6 + 10 +

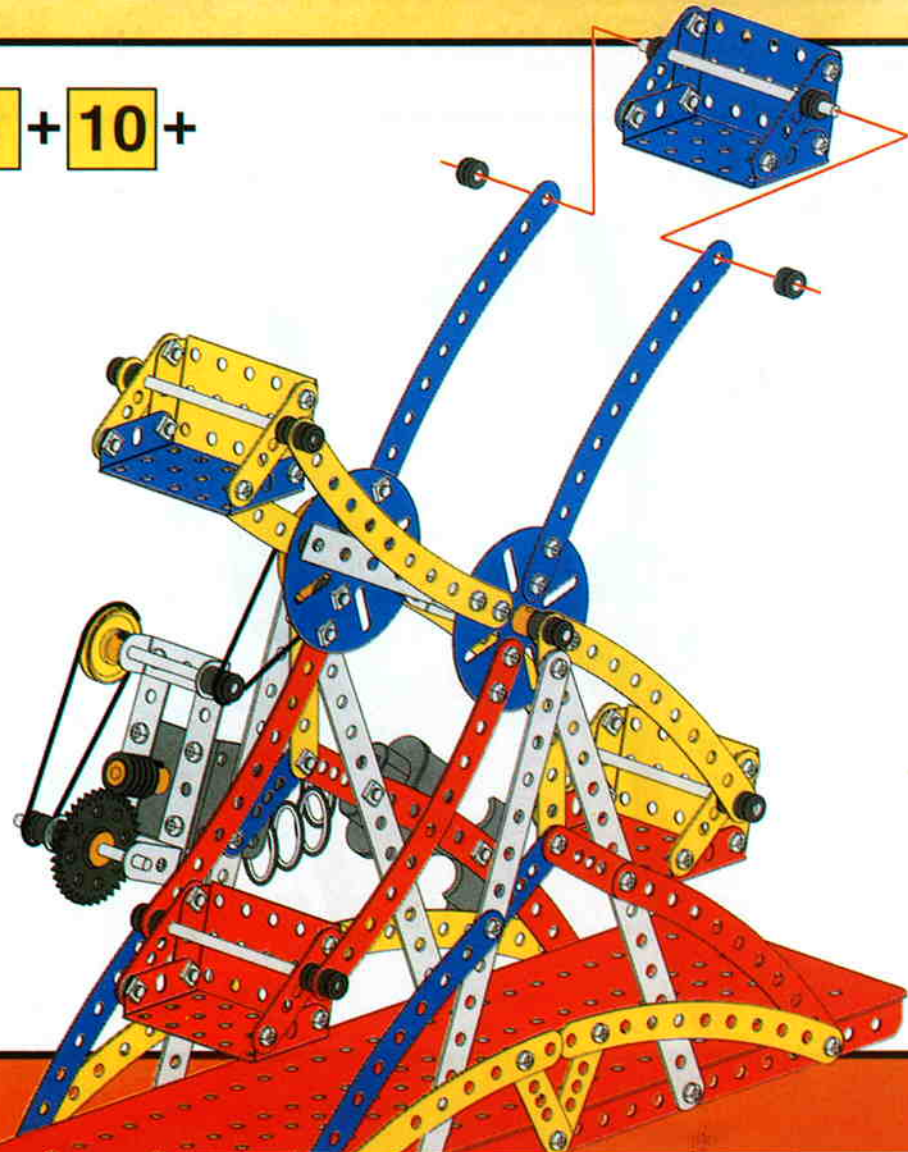
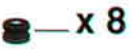

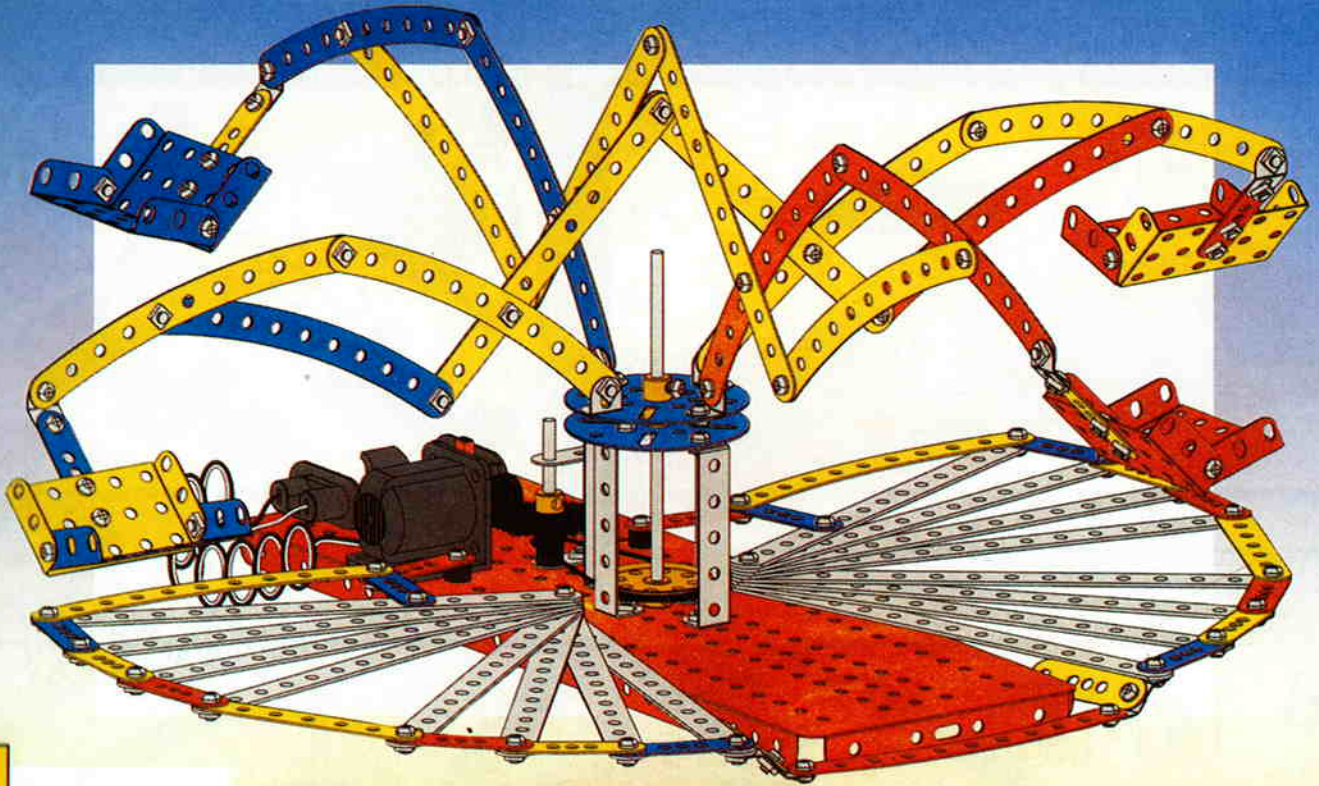

1

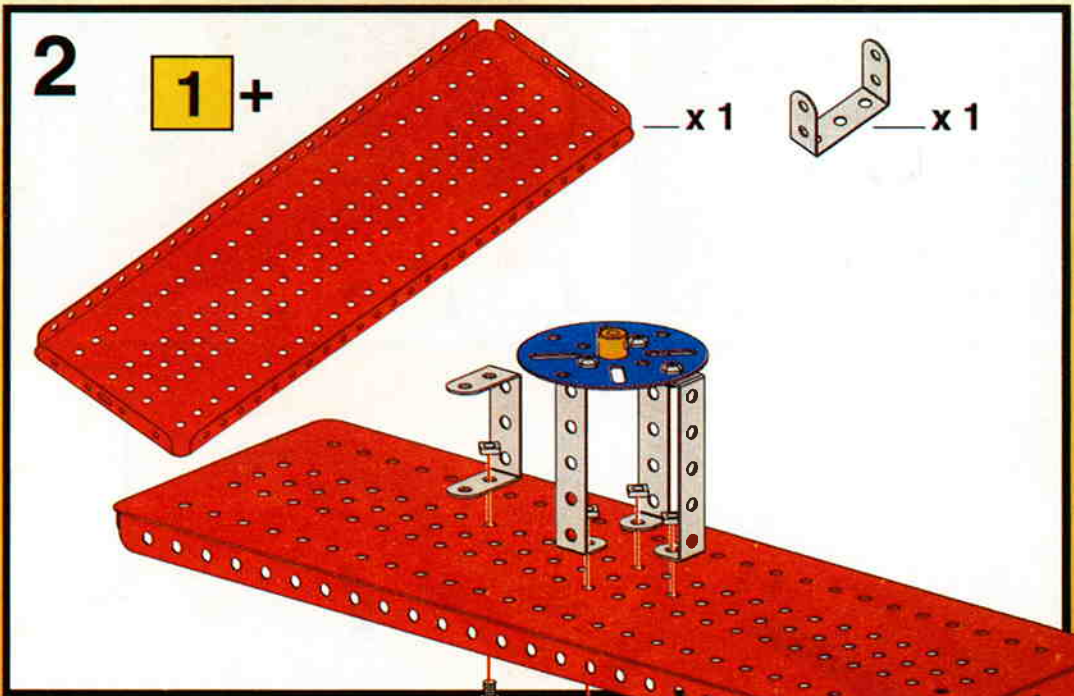
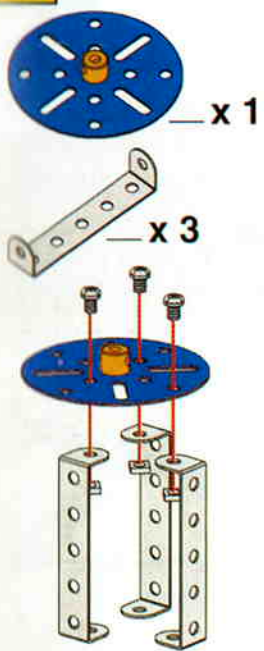

3

2 +

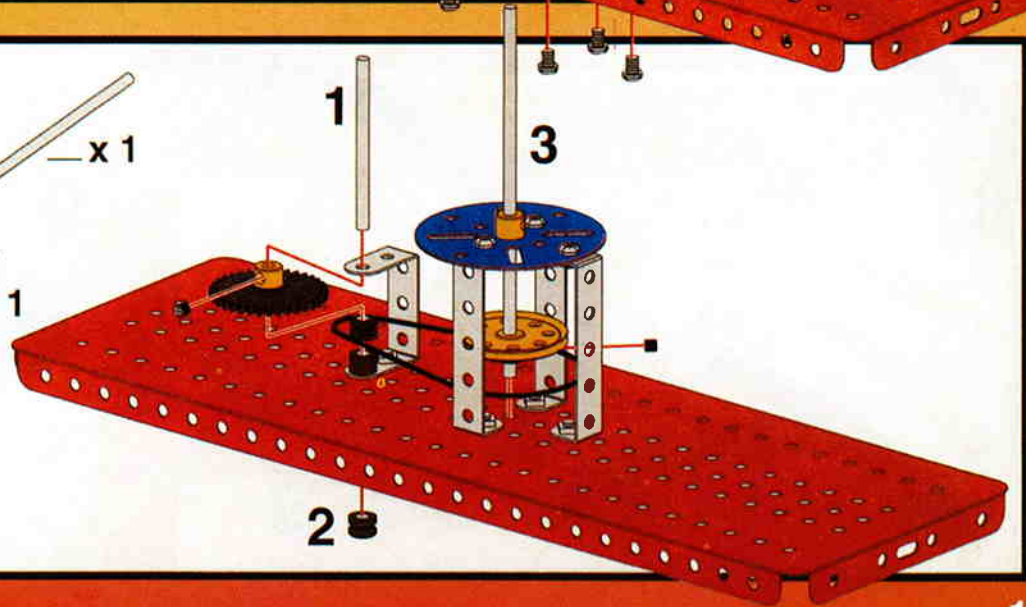
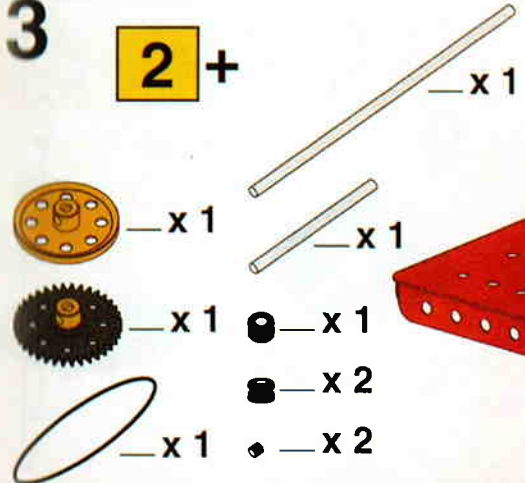

10

7 + 8 + 9

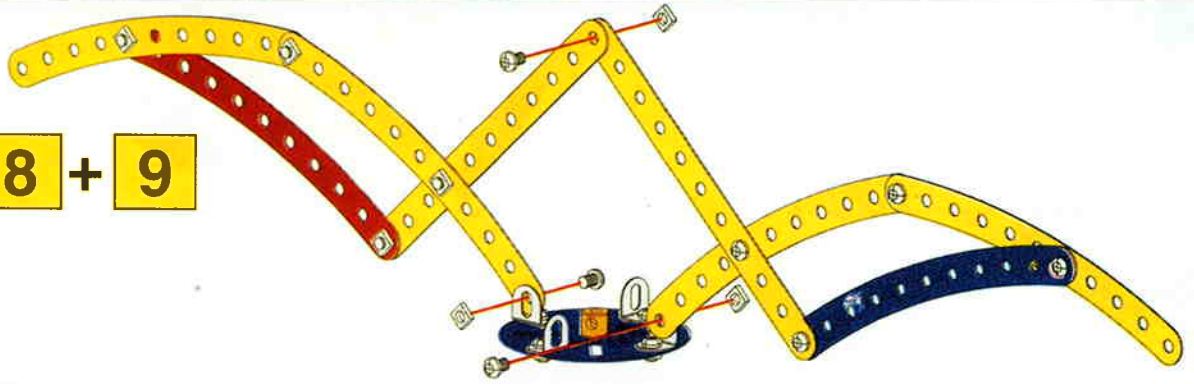

11

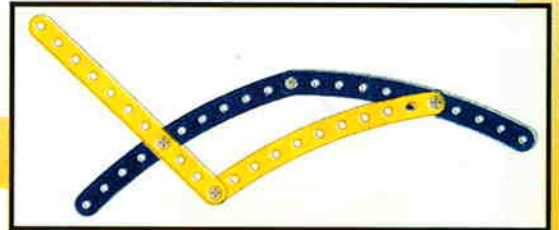
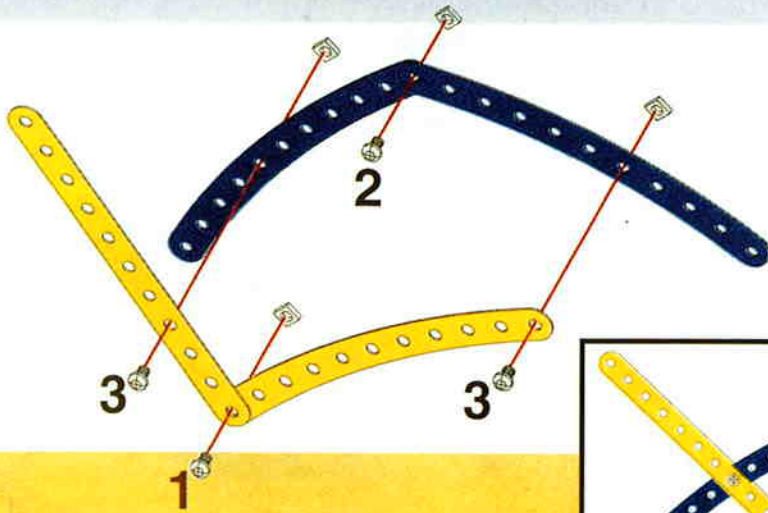
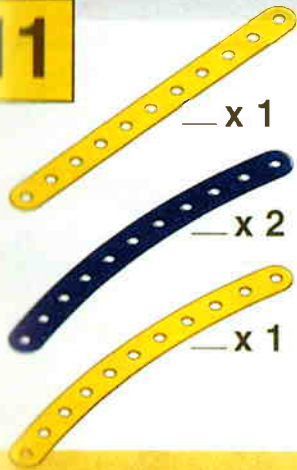

12

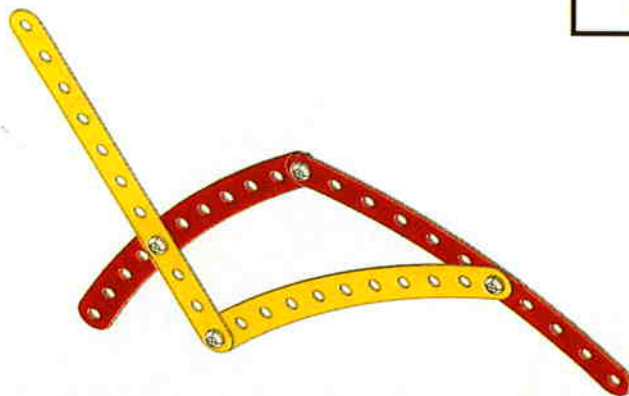
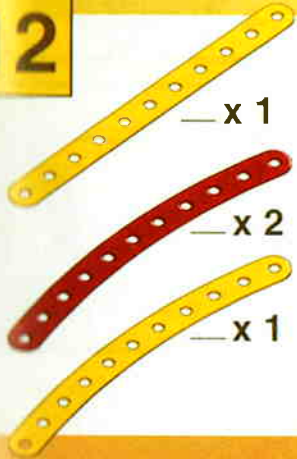

13

10 + 11 + 12

